

Feature:

- Package in tape and reel
- Ultra bright reflector type PLCC2 LED
- Special polarity
- AlInGaP technology for Red
- 120 degree viewing angle

Description:

These ultra bright reflector type PLCC2 LEDs have a height profile of 1.90mm. Combination of high brightness output and robust package, these LEDs are ideal for architecture lighting, status indication, and industrial equipment lighting applications.

Application:

- Status indication
- Industrial equipment backlighting
- Architecture lighting

Certification & Compliance:

- TS16949
- ISO9001
- RoHS Compliant

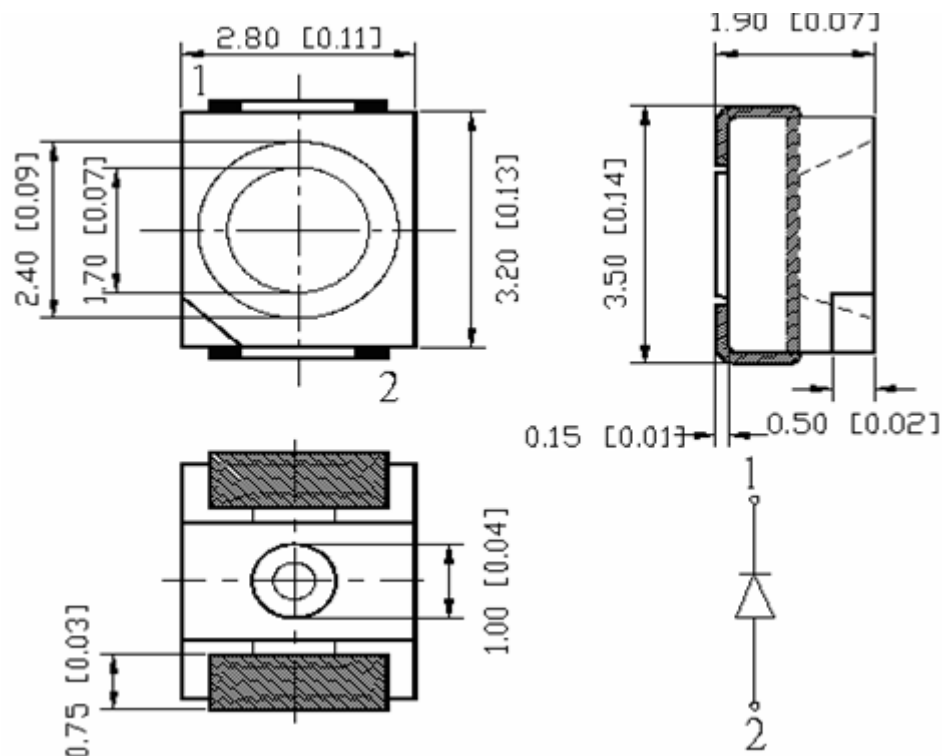
Dimension:

Units: mm / tolerance = +/-0.1mm

Electrical / Optical Characteristic (T=25 °C)

Product	Color	I _F (mA)	V _F (V)		λ _D (nm)			I _V (mcd)	
			Typ.	max	Min.	Typ.	Max.	min	Typ.
QBLP670-R-1710	Red	20	1.9	2.4	620	---	635	320	630

Absolute Maximum Rating

Part #	P _d (mW)	I _F (mA)	I _{FP} (mA)*	V _R (V)	T _{OP} (°C)	T _{ST} (°C)	T _{SOL} (°C)**
AlInGaP (Red)	90	30	100	5	-30 - 80	-40 - 100	260

*Duty 1/10 @ 10KHz

** IR Reflow for no more than 10 sec @ 260 °C

Characteristic Curves:

AllnGaP(Red)

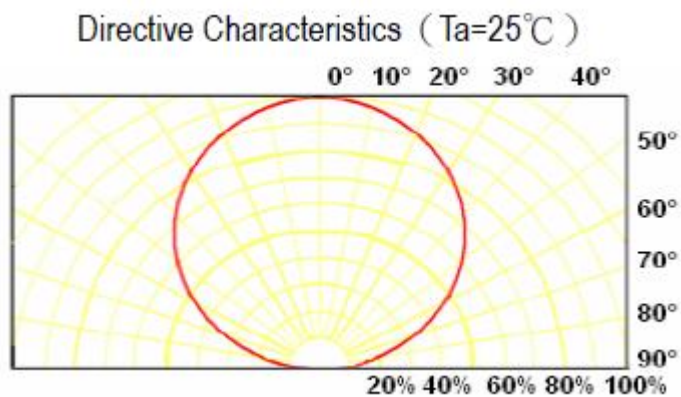
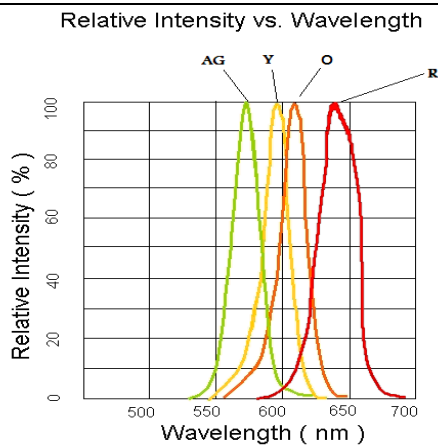
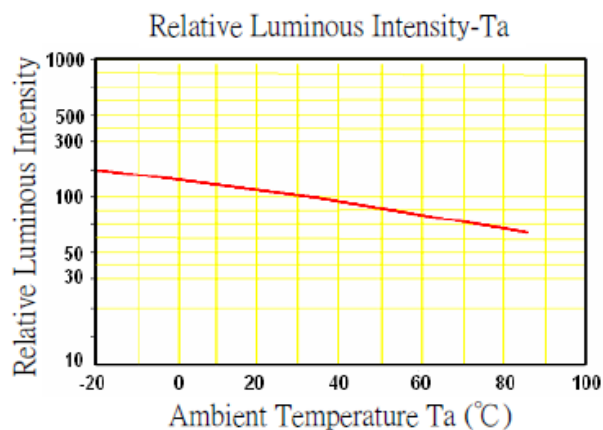
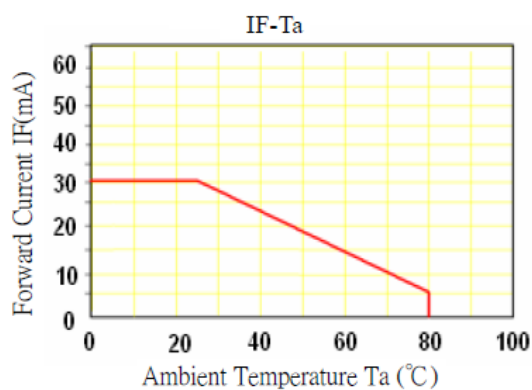
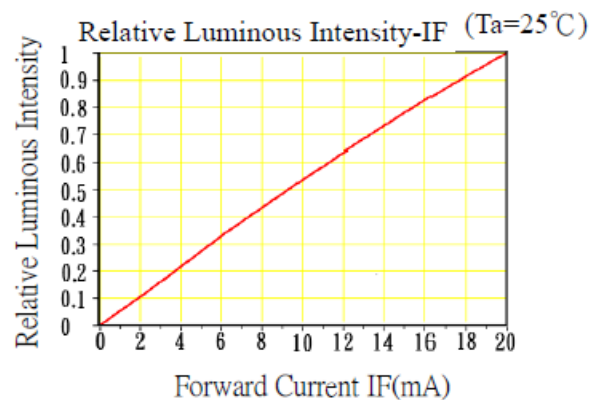
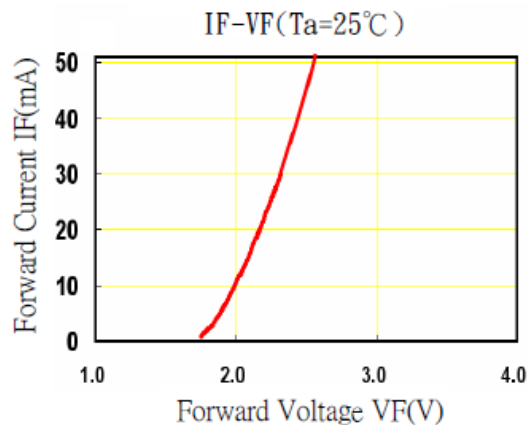

Solder Profile & Footprint:

- Recommended tin glue specifications: melting temperature in the range of 178~192 °C
- The recommended reflow soldering profile is as follows (temperatures indicated are as measured on the surface of the LED resin):

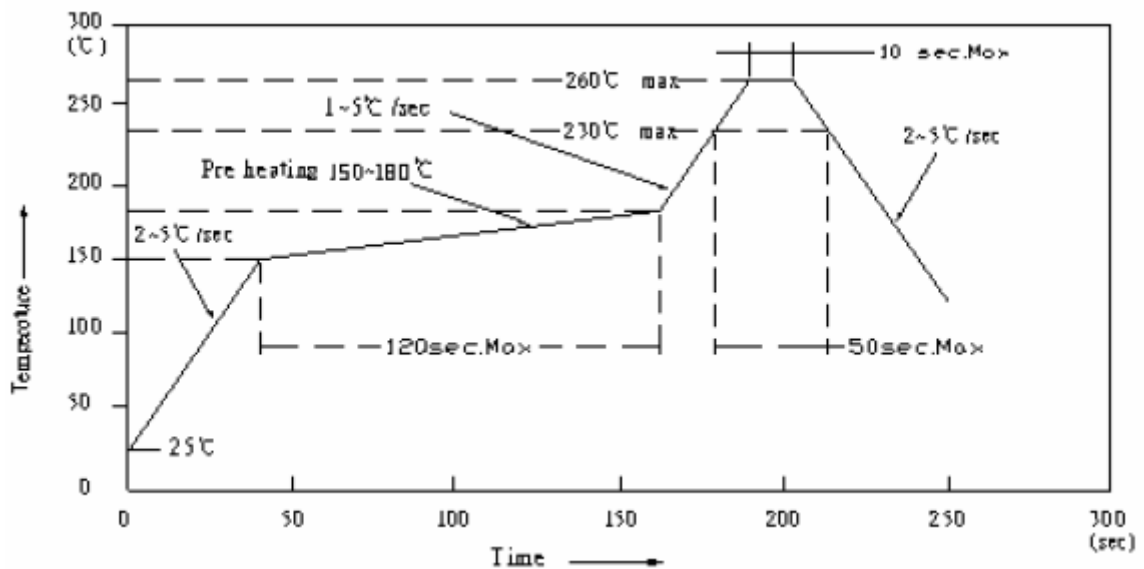

RECOMMEND PADLAYOUT

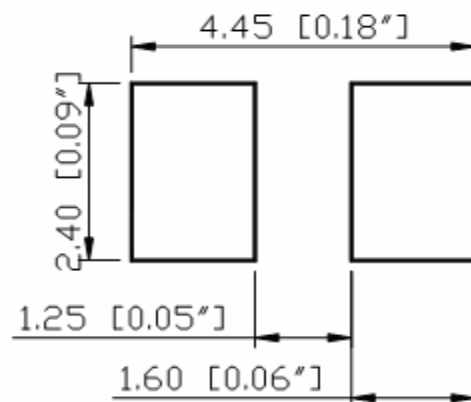

Units: mm

tolerance: +/- 0.1mm

Packing:

Reel Dimension:

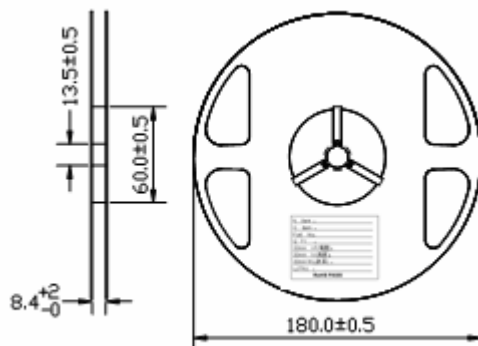

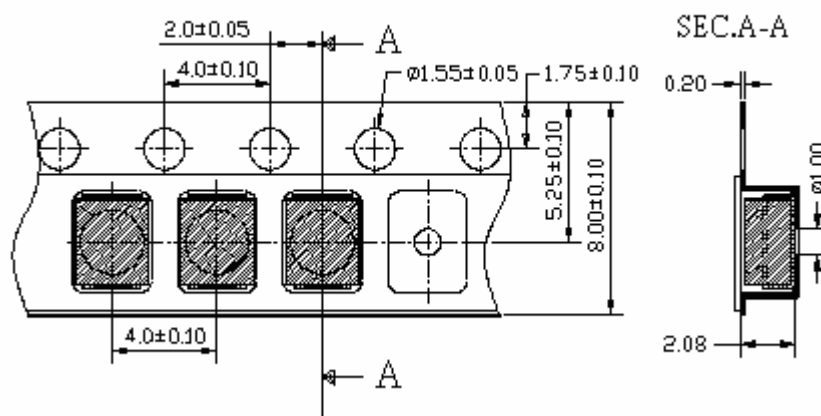

Tape Dimension:



(Unit in mm)

Product: QBLP670-R-1710	Date: May 17, 2011	Page 5 of 7
	Version# 1.1	

Labeling:

	QT-Brighttek	
		
Part No: _____		
Customer P/N: _____		
Item: _____		
Q'ty: _____		
Vf: _____		
Iv: _____		
WI: _____		
Date: _____		
Made in China		

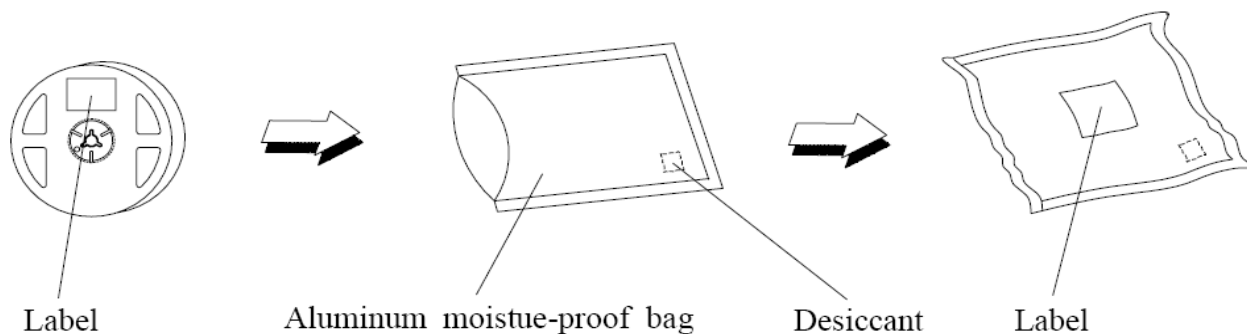
**Ordering Information:**

Part #	Orderable Part #	Spec Range	Quantity per reel
QBLP670-R-1710	QBLP670-R-1710	Iv = 630 mcd Typ. @ 20mA/ Color = 620-635nm	2,000 units

Product: QBLP670-R-1710	Date: May 17, 2011	Page 6 of 7
	Version# 1.1	

Revision History:

Description:	Revision #	Revision Date
New Release of QBLP670-R-1710	V1.0	03/10/2011
Amend polarity and label format	V1.1	5/17/2011
*Part with special polarity		